



Instruction Manual

Drill & Learn

Motorised Monster Truck™



INTRODUCTION

Thank you for purchasing the **Drill & Learn Motorised Monster Truck™**.
Learn fun truck facts in Discovery Mode or get to work with Wreck & Repair mini games. Fix the hood and replace the tires with the included tools.



INCLUDED IN THE PACKAGE

- 1 Motorised Monster Truck



- 1 Drill



- 1 Hood



- 1 Front Bumper



- 5 Screws



- 4 Tires



- 1 Label Sheet



- Quick Start Guide



WARNING

All packing materials such as tape, plastic sheets, packaging locks, removable tags, cable ties, cords and packaging screws are not part of this toy, and should be discarded for your child's safety.

NOTE

Please save this Instruction Manual as it contains important information.

Unlock the Packaging Locks:

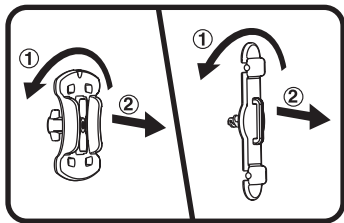

- ① Turn the packaging locks anticlockwise several times.
- ② Pull out and discard the packaging locks.

For packaging purposes only.

Please discard for your child's safety.

Remove the Cable Ties:



- ① Cut the ties with a pair of scissors.
- ② Remove the ties.

WARNING

Do not put any other object other than the screw provided in the threaded hole on the hood.

NOTE

1. Keep your body, hair and clothing away from the moving truck. If something gets caught in the truck wheels, turn the truck **Off** by sliding the **On/Off/Mode** Selector to the **Off** position.

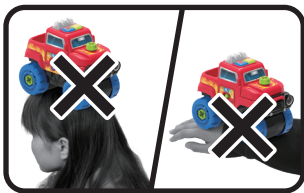

2. If wheels loosen while playing, use the drill to tighten loose screws.



3. Do not leave the truck outside. Motor will perform best on flat surfaces. Do not operate the truck on tables, counter-tops or other elevated surfaces.



ACTIVATING NORMAL PLAY MODE

The first time the **Drill & Learn Motorised Monster Truck™** is used, you will need to exit **Try-Me** mode and activate **Normal Play** mode. Power **On** the unit and loosen the screw on the hood. You will hear 2 beeps to indicate **Normal Play** mode is activated. After **Normal Play** mode is activated, press down the engine, replace the hood and install the screw. You are ready to play.

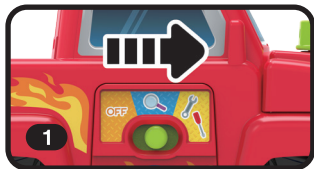

GETTING STARTED

Battery Removal and Installation

1. Make sure the unit is turned **Off**.
2. Find the battery cover located on the bottom of the unit. Use a screwdriver to loosen the screw and then open the battery cover.
3. Remove old batteries by pulling up on one end of each battery.
4. Install 3 new AA (AM-3/LR6) batteries following the diagram inside the battery box. (For best performance, alkaline batteries or fully charged Ni-MH rechargeable batteries are recommended.)
5. Replace the battery cover and tighten the screw to secure.

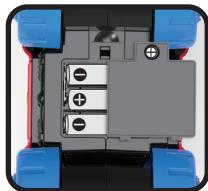
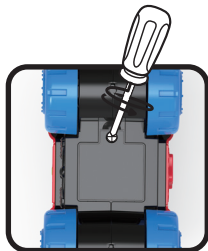



WARNING:

Adult assembly required for battery installation.

Keep batteries out of reach of children.

IMPORTANT: BATTERY INFORMATION

- Insert batteries with the correct polarity (+ and -).
- Do not mix old and new batteries.
- Do not mix alkaline, standard (carbon-zinc) or rechargeable batteries.
- Only batteries of the same or equivalent type as recommended are to be used.
- Do not short-circuit the supply terminals.
- Remove batteries during long periods of non-use.
- Remove exhausted batteries from the toy.
- Dispose of batteries safely. Do not dispose of batteries in fire.

RECHARGEABLE BATTERIES:

- Remove rechargeable batteries (if removable) from toy before charging.
- Rechargeable batteries are only to be charged under adult supervision.
- Do not charge non-rechargeable batteries.

ASSEMBLY INSTRUCTIONS

1. Move the switch left to get the **Drill** ready. Press the trigger to turn the **Drill** clockwise and tighten the screw.



2. Use the **Drill** to screw the wheels onto the truck.

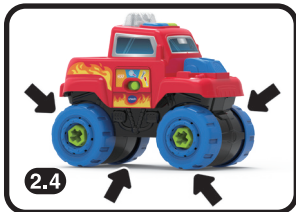
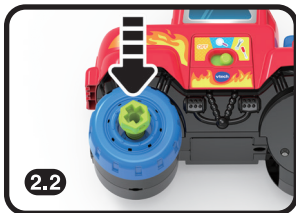

3. Follow the below steps to install the hood.

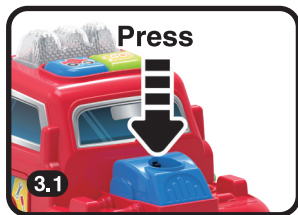

4. Hang the bumper on the front of the hood and store the **Drill** in the back of the **Truck**.



LABEL APPLICATION

Please secure labels onto the vehicle as shown below.

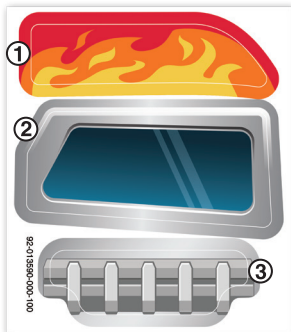

PRODUCT FEATURES

1. On/Off/Mode Selector

Slide the selector to **Discovery** or **Mission Mode** to turn the unit **On**. Slide the switch to the left to turn the unit **Off**.

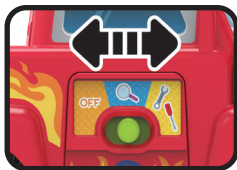

2. Truck Button



- In **Discovery Mode** press for role play fun, counting and Monster Truck facts.
- In **Repair Mode** press to start or complete maintenance & repair mini games.



3. Go Button

- In **Discovery Mode** press to drive the truck, hear sung songs and learn about road safety.
- In **Repair Mode** press for Truck repair assignments.



4. Light Bar

- In **Discovery Mode** press to learn about road safety, numbers and counting from 1-5.
- In **Repair Mode** press to play maintenance & repair mini games.



5. Screw On Hood

- Loosen the **Screw** to remove the hood.
- Tighten the **Screw** to attach the hood and complete repairs.

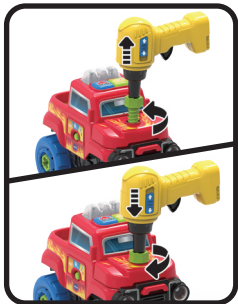

NOTE:

If the unit powers down while playing or the truck stops moving, please install a new set of batteries.

ACTIVITIES

1. Discovery Mode

Slide the **On/Off/Mode Selector** to the centre. Then, press any button for role play and learning. Hear about truck features, numbers, counting, and basic road safety.



2. Repair Mode

Slide the **On/Off/Mode Selector** to the right. Then press the **Light Bar** to start maintenance & repair mini games.

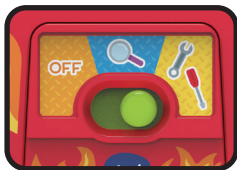

SONG LYRICS

Song 1

I'm a Monster truck,
and I'm feeling fine.
Fix me up,
and we'll hit the track on time!

Song 2

Use the drill, to tighten my screws,
then let's get driving, just me and you!

Song 3

My body is tough, and my tires are too,
I love driving in the mud, oh yes I do!

CARE & MAINTENANCE

1. Keep the unit clean by wiping it with a slightly damp cloth.
2. Keep the unit out of direct sunlight and away from any direct heat sources.
3. Remove the batteries if the unit will not be in use for an extended period of time.
4. Do not drop the unit on hard surfaces and do not expose the unit to moisture or water.
5. If the unit stops working or malfunctions, install a new set of batteries.

TROUBLESHOOTING

If for some reason the unit stops working or malfunctions, please follow these steps:

1. Turn the unit **Off**.
2. Interrupt the power supply by removing the batteries.
3. Let the unit stand for a few minutes, then replace the batteries.
4. Turn the unit **On**. The unit should now be ready to use again.
5. If the unit still does not work, install a new set of batteries.

CONSUMER SERVICES

Creating and developing VTech products is accompanied by a responsibility that we at **VTech®** take very seriously. We make every effort to ensure the accuracy of the information, which forms the value of our products. However, errors sometimes can occur. It is important for you to know that we stand behind our products and encourage you to call our Consumer Services Department with any problems and/or suggestions that you might have. A service representative will be happy to help you.

Australian Customers:

Phone: 1800 862 155

Website: support.vtech.com.au

NZ Customers:

Phone: 0800 400 785

Website: support.vtech.com.au

PRODUCT WARRANTY/ CONSUMER GUARANTEES

Australian Customers:

VTECH ELECTRONICS (AUSTRALIA) PTY LIMITED – CONSUMER GUARANTEES

Under the Australian Consumer Law, a number of consumer guarantees apply to goods and services supplied by VTech Electronics (Australia) Pty Limited. Please refer to vtech.com.au/consumerguarantees for further information.

**Visit our website for more
information about our products,
downloads, resources and more.**

www.vtech.com.au

